



D815 Tessmann Worlds Edition

Driver Ty Tessmann

Date Sept 2014

Track Naxos Giardini World

Event IFMAR 1/8 worlds

Track Condition Concrete, High bite, Open layout, High speed.

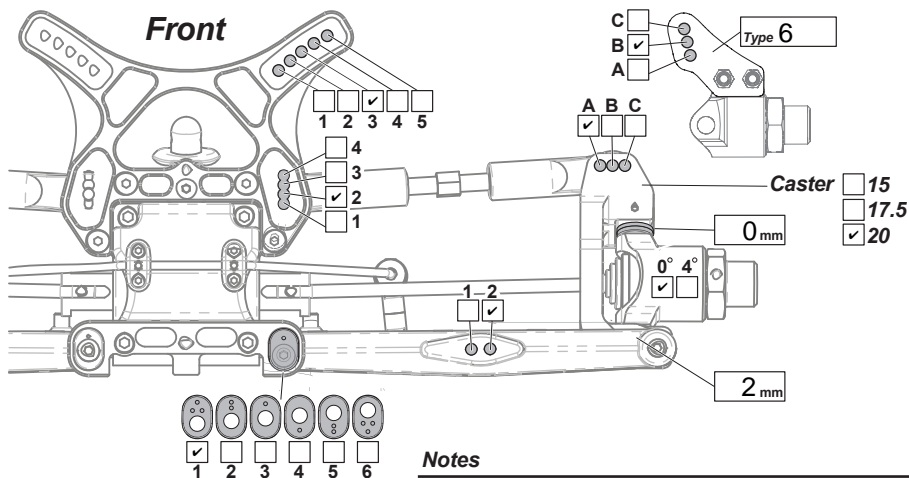

Ride Height 27 mm
 Camber Angle -1°
 Toe Angle .5 out°
 Sway Bar 2.4 mm
 Shock Length 106 mm

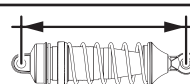

Front Shocks	
Oil weight	42.5 wt
Piston	6x1.3 mm
Bladder	shock bellow
Spring	HB Yellow

Notes

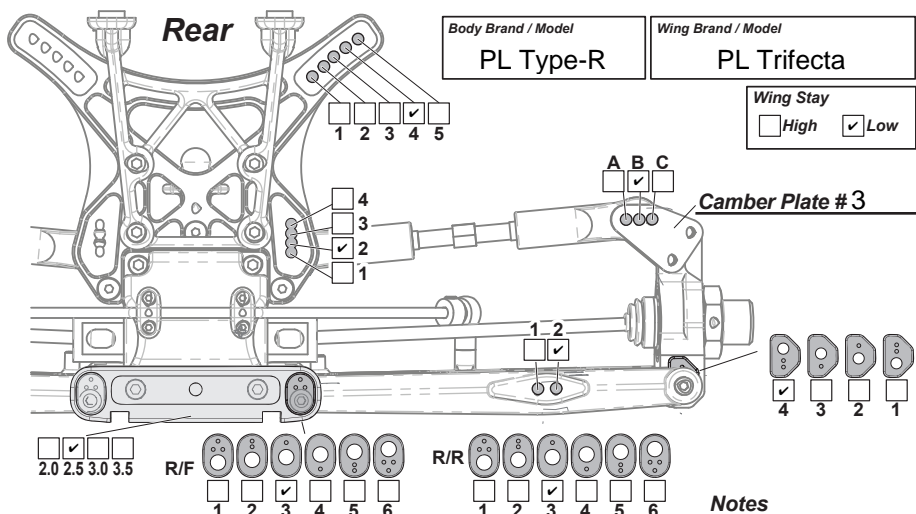

Ride Height 27 mm
 Camber Angle -1.5°
 Sway Bar 2.6 mm
 Shock Length 123 mm

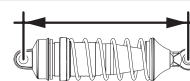

Rear Shocks	
Oil weight	37.5 wt
Piston	6x1.3 mm
Bladder	shock bellow
Spring	HB Blue

Notes

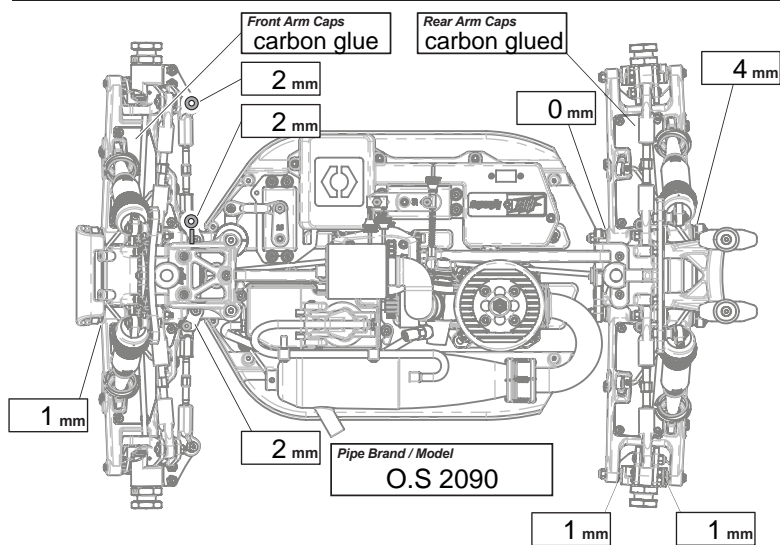

Engine	
Brand	O.S 2101
Spur gear	48
Pinion gear	13
Clutch	3 shoe aluminum
Glow Plug	O.S P3
Glow Fuel	Nitrotane 25%

Tires	Front	Rear
Brand	Proline	Fugitive
Compound	X1	X1
Insert	Closed	Cell
Wheel	Proline	Proline
Notes		

Diff Oils	Front	Center	Rear
	Brand	Losi	Losi
Oil Weight / Grade	15K	10K	5K

Notes Diffs 100% full.